

INSTRUCTION MANUAL

A. Features of the product

1. Control the gel leakage while using the product
2. Control knob allows exact amount to be applied on the application area
3. Capacity control will reduce the expenses on bait and gel

B. Operation

1. Push the metal rod into the cartridge by 1 to 1.5 cm
2. Insert rubber head of the rod in an oblique angle to evacuate air in the middle
3. Softly insert the rod till the rubber head reach the end of cartridge
4. Twist the cartridge to fix to the gun
5. Remove the tip of cartridge and pull trigger slightly to check it is working
6. Check the gel amount and set control knob to the right position by your demand

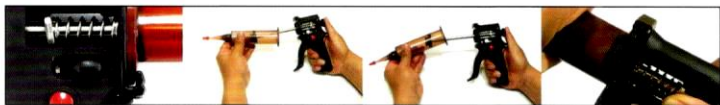

C. Operation of gel control knob

Move the knob into right position by opening screw and move knob

1. Left (L mark): for area where 1 or 2 cockroaches are found
2. Middle (M mark): for area where many cockroaches are found
3. Right (R mark): for area where big cockroaches are found (American type)

D. Caution

1. Please use the bait gun with proper strength
2. Rubber head (o shaped rubber) required to be a different size by the type of cartridge. Rubber head is preventing the gel leaking from the head to the bottom when piston is pushed back.

E. Part List

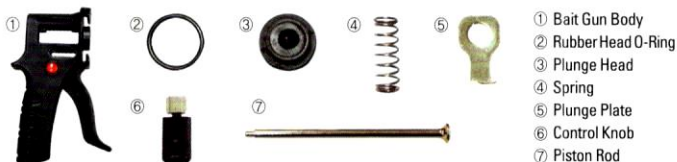

- ① Bait Gun Body
- ② Rubber Head O-Ring
- ③ Plunge Head
- ④ Spring
- ⑤ Plunge Plate
- ⑥ Control Knob
- ⑦ Piston Rod